

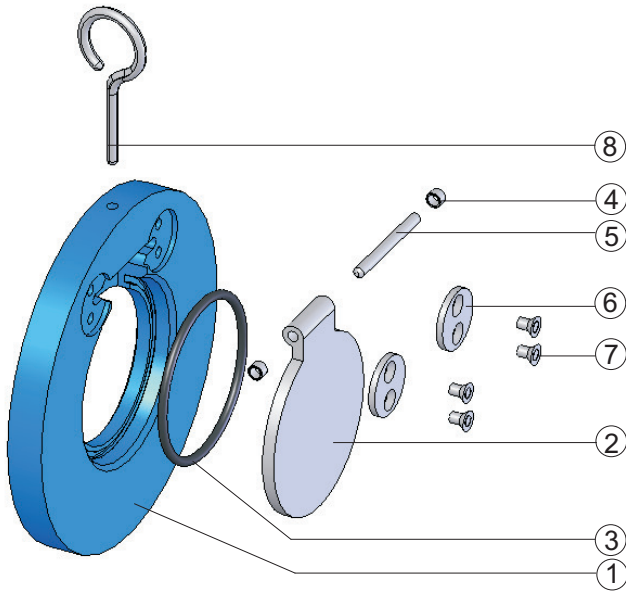

# 4310 CHECK VALVE PARTS LIST

# 4311 CHECK VALVE (ELASTOMER COATED) PARTS LIST



## 4310

Ø 25 - 600

### Parts List & Material Specification

P.NO	PART NAME	MATERIAL
1	Body	C 45 / St 37 - AISI 316 - Al-Bz
2	Disc	C 45 / St 37 - AISI 316
3	O-Ring	EPDM - Nitril - Viton
4	Bushing	AISI 304
5	Pin	AISI 304
6	Washer	AISI 304
7	Bolt	A-2
8	Hook bolt	C 45

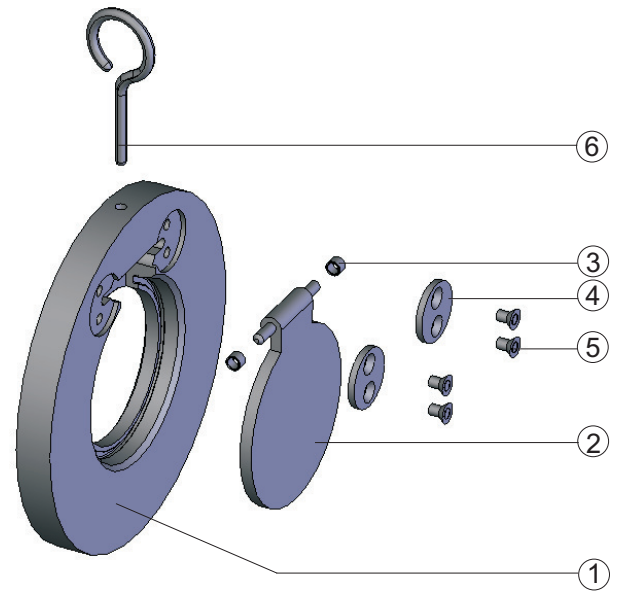

## 4311

Ø 250 - 900

### Parts List & Material Specification

P.NO	PART NAME	MATERIAL
1	Body	AISI 316, C 45 / St 37, Al Bz
2	Disc	C 45 / St 37 Elastomer Coated, AISI 316
3	Bushing	AISI 316, AISI 304
4	Washer	AISI 316, AISI 304
5	Bolt	A2
6	Hook bolt	C 45